

CUMHURBAŞKANI KARARI

**Karar Sayısı: 3027**

Diyarbakır İli, Bağlar İlçesi, Kaynartepe Mahallesi sınırları içerisinde bulunan ve ekli kroki ile listede sınır ve koordinatları gösterilen alanın riskli alan ilan edilmesine, 6306 sayılı Afet Riski Altındaki Alanların Dönüştürülmesi Hakkında Kanununun 2 nci ve ek 1 inci maddeleri gereğince karar verilmiştir.

25 Eylül 2020

Recep Tayyip ERDOĞAN
CUMHURBAŞKANI

25/9/2020 TARİHLİ VE 3027 SAYILI CUMHURBAŞKANI KARARININ EKI
KROKİ VE LİSTE

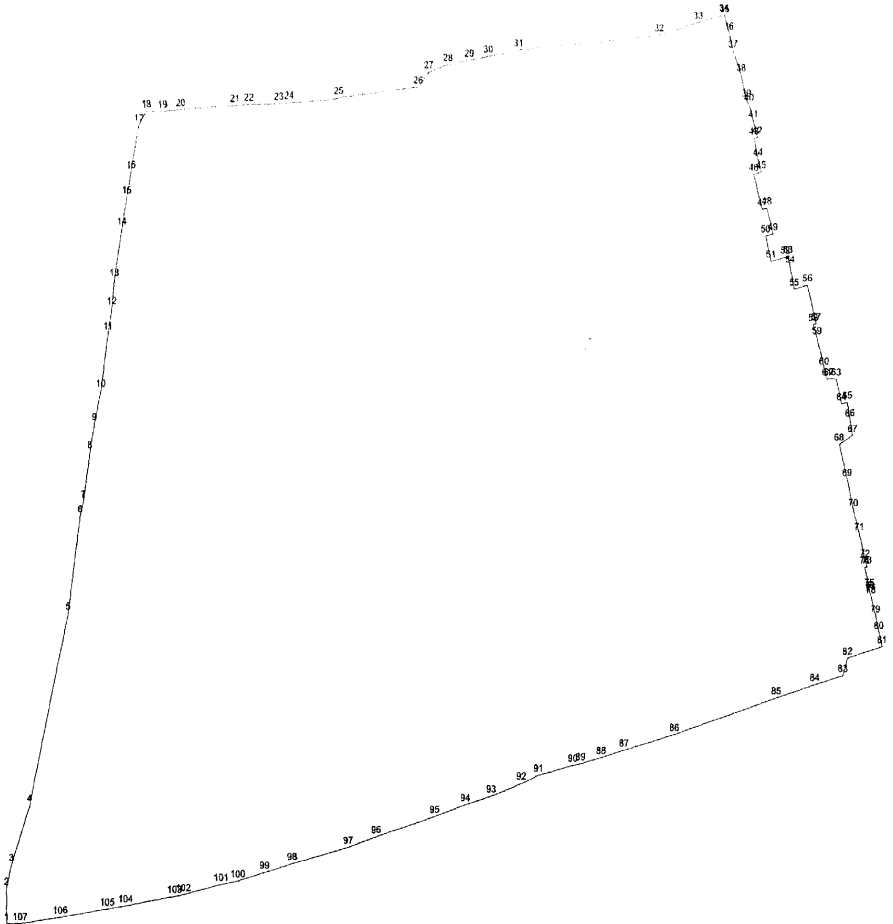

DIYARBAKIR İLİ, BAĞLAR İLÇESİ,
KAYNARTEPE MAHALLESİ
RİSKLİ ALAN SINIRI KROKİSİ

Alan Büyüklüğü: 5.3617 Hektar

**DİYARBAKIR İLİ, BAĞLAR İLÇESİ,
KAYNARTEPE MAHALLESİ
RİSKLİ ALAN SINIRI KOORDİNAT LİSTESİ**

Nokta No	Y	X	Nokta No	Y	X
1	606247.321	4199025.766	2	606247.381	4199036.056
3	606249.131	4199043.106	4	606255.430	4199060.466
5	606268.900	4199116.855	6	606273.250	4199145.355
7	606274.356	4199149.598	8	606276.700	4199164.115
9	606278.330	4199172.285	10	606280.630	4199182.175
11	606283.200	4199199.075	12	606284.580	4199206.405
13	606285.540	4199214.665	14	606288.210	4199229.565
15	606290.030	4199238.675	16	606291.540	4199245.865
17	606294.330	4199259.325	18	606296.920	4199263.365
19	606302.350	4199263.295	20	606308.490	4199263.745
21	606326.840	4199264.975	22	606331.490	4199265.235
23	606341.410	4199265.515	24	606344.890	4199265.755
25	606361.680	4199267.105	26	606388.700	4199270.115
27	606392.320	4199274.505	28	606398.940	4199276.605
29	606406.140	4199277.865	30	606412.650	4199279.105
31	606422.800	4199280.805	32	606470.090	4199284.965
33	606483.440	4199288.575	34	606492.320	4199290.845
35	606492.390	4199290.585	36	606493.890	4199285.415
37	606495.180	4199290.275	38	606497.820	4199273.385
39	606499.560	4199266.085	40	606500.460	4199264.765
41	606501.800	4199259.925	42	606503.120	4199255.155
43	606501.970	4199254.865	44	606503.260	4199248.745
45	606504.270	4199245.085	46	606501.760	4199244.375
47	606504.450	4199234.125	48	606506.090	4199234.505
49	606508.020	4199227.005	50	606505.540	4199226.365
51	606507.240	4199218.985	52	606512.200	4199220.095
53	606513.170	4199220.305	54	606513.800	4199217.445
55	606515.132	4199210.738	56	606519.580	4199211.885
57	606522.290	4199200.445	58	606521.320	4199200.205
59	606522.490	4199196.325	60	606524.800	4199187.285
61	606525.660	4199183.985	62	606526.310	4199184.085
63	606528.740	4199183.975	64	606530.470	4199176.665
65	606532.390	4199177.105	66	606533.224	4199171.868
67	606533.970	4199167.185	68	606529.470	4199164.685
69	606531.987	4199154.227	70	606533.880	4199145.335
71	606535.810	4199138.245	72	606537.650	4199130.355
73	606538.260	4199128.425	74	606537.450	4199128.255
75	606538.970	4199121.825	76	606539.180	4199120.925
77	606539.340	4199120.275	78	606539.490	4199119.665
79	606540.900	4199113.965	80	606541.970	4199109.065
81	606542.960	4199104.815	82	606531.250	4199101.605
83	606529.660	4199096.485	84	606520.270	4199093.825
85	606507.040	4199090.125	86	606472.400	4199079.555
87	606455.250	4199075.095	88	606447.570	4199073.035
89	606440.730	4199071.285	90	606438.120	4199070.815
91	606426.570	4199067.975	92	606420.910	4199065.735
93	606410.750	4199062.155	94	606402.020	4199059.605
95	606391.470	4199056.265	96	606371.680	4199050.505
97	606362.130	4199047.385	98	606343.150	4199042.845
99	606333.980	4199040.475	100	606325.080	4199038.035
101	606319.450	4199036.985	102	606306.691	4199034.105
103	606303.751	4199033.605	104	606287.081	4199030.945
105	606280.851	4199029.975	106	606265.161	4199027.646
107	606251.741	4199025.766			

PROJEKSİYON: UTM 3
DATUM: ITRF 96
DİLİM ORTA BOYLAM: 39