

CUMHURBAŞKANI KARARI



Karar Sayısı: 2389

Uşak İli, Merkez İlçe, Hacıkadem, Dikilitaş ve Karaağaç mahalleleri sınırları içerisinde yer alan bazı alanların kentsel dönüşüm ve gelişim proje alanı ilan edilmesine ilişkin ekli Kararın yürürlüğe konulmasına, 5393 sayılı Belediye Kanununun 73 üncü maddesi gereğince karar verilmiştir.

10 Nisan 2020

Recep Tayyip ERDOĞAN
CUMHURBAŞKANI

**10/4/2020 TARİHLİ VE 2389 SAYILI
CUMHURBAŞKANI KARARININ EKİ**

KARAR

Kentsel dönüşüm ve gelişim proje alanı

MADDE 1- (1) Uşak İli, Merkez İlçe, Hacıkadem, Dikilitaş ve Karaağaç mahalleleri sınırları içerisinde bulunan ve ekli kroki ile listede sınır ve koordinatları gösterilen alan, kentsel dönüşüm ve gelişim proje alanı ilan edilmiştir.

(2) Birinci fıkra kapsamında ilan edilen kentsel dönüşüm ve gelişim proje alanı içerisinde yer alan ve harca esas değer üzerinden belediyelere devredilen Hazineye ait taşınmazlar, kentsel dönüşüm ve gelişim amacına yönelik imar planı ve uygulaması yapılmadan satılamaz.

Yürürlük

MADDE 2- (1) Bu Karar yayımı tarihinde yürürlüğe girer.

Yürütme

MADDE 3- (1) Bu Karar hükümlerini Çevre ve Şehircilik Bakanı yürütür.

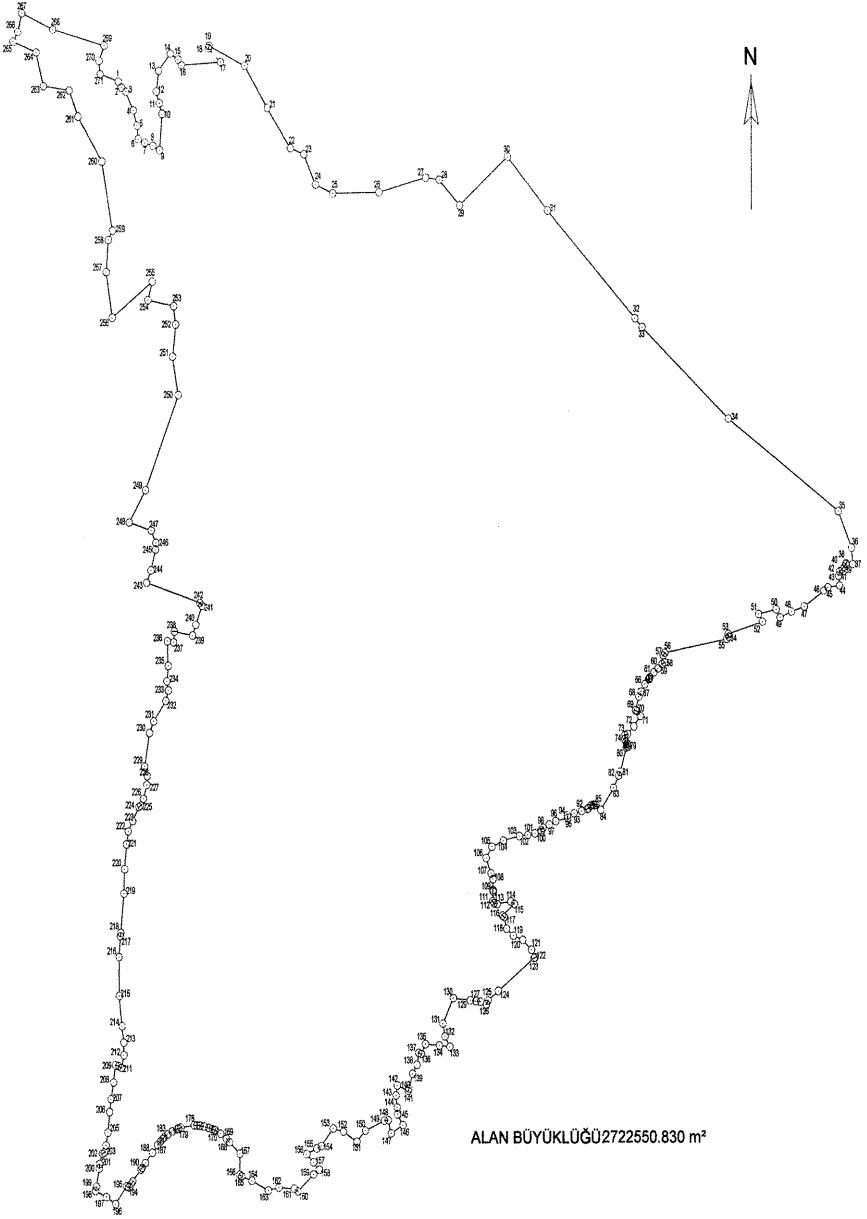

ALAN BÜYÜKLÜĞÜ 2722550.830 m²

UŞAK İLİ MERKEZ İLÇE
HACIKADEM-DİKİLİTAŞ-KARAAĞAÇ MAHALLELERİ
KENTSEL DÖNÜŞÜM VE GELİŞİM PROJE ALANI
SINIR KROKİSİ

UŞAK İLİ MERKEZ İLÇE
HACIKADEM-DİKİLİTAŞ-KARAAĞAÇ MAHALLELERİ
KENTSEL DÖNÜŞÜM VE GELİŞİM PROJE ALANI
KOORDİNAT LİSTESİ

Nokta No	Y	X	Nokta No	Y	X
1	444965.65	4285634.32	60	446356.94	4284358.00
2	444973.15	4285621.14	61	446346.56	4284349.55
3	444984.33	4285611.92	62	446335.88	4284338.41
4	445004.01	4285571.64	63	446333.82	4284336.00
5	445013.83	4285538.51	64	446334.21	4284334.59
6	445016.79	4285509.50	65	446332.55	4284334.34
7	445034.01	4285501.79	66	446322.74	4284323.07
8	445054.68	4285495.53	67	446312.64	4284306.81
9	445071.95	4285486.08	68	446306.91	4284295.68
10	445078.11	4285564.81	69	446298.26	4284266.20
11	445071.18	4285587.33	70	446302.40	4284264.08
12	445063.66	4285562.83	71	446311.06	4284253.77
13	445069.85	4285658.76	72	446293.82	4284231.21
14	445100.43	4285697.85	73	446277.43	4284214.39
15	445120.49	4285685.00	74	446270.43	4284212.01
16	445128.69	4285672.44	75	446269.81	4284203.30
17	445230.52	4285679.71	76	446272.60	4284197.23
18	445199.12	4285710.59	77	446276.27	4284193.32
19	445201.10	4285715.44	78	446275.05	4284189.24
20	445292.41	4285672.16	79	446277.62	4284186.27
21	445350.65	4285579.34	80	446273.73	4284184.84
22	445410.70	4285492.60	81	446257.97	4284132.02
23	445445.75	4285479.83	82	446253.83	4284123.51
24	445475.08	4285414.29	83	446240.22	4284096.53
25	445519.25	4285395.14	84	446207.46	4284048.52
26	445638.19	4285398.57	85	446194.96	4284058.72
27	445758.65	4285430.84	86	446193.68	4284059.93
28	445793.67	4285426.54	87	446190.45	4284058.32
29	445846.07	4285371.28	88	446188.16	4284060.21
30	445969.40	4285477.43	89	446181.66	4284057.71
31	446074.04	4285361.59	90	446175.20	4284051.69
32	446300.21	4285126.15	91	446172.21	4284050.57
33	446318.81	4285106.79	92	446157.73	4284046.09
34	446540.98	4284908.47	93	446138.32	4284040.83
35	446826.68	4284706.21	94	446120.37	4284036.03
36	446861.47	4284625.26	95	446121.05	4284030.54
37	446864.06	4284589.14	96	446090.37	4284023.78
38	446846.56	4284590.60	97	446073.26	4284016.38
39	446845.95	4284589.42	98	446057.26	4284009.58
40	446841.26	4284582.92	99	446051.75	4284004.16
41	446836.29	4284578.10	100	446052.40	4284000.69
42	446829.43	4284573.23	101	446035.87	4283996.96
43	446826.78	4284563.38	102	446017.25	4283993.40
44	446829.40	4284541.85	103	445995.33	4283991.17
45	446798.49	4284537.94	104	445953.41	4283981.08
46	446787.10	4284530.17	105	445923.94	4283967.70
47	446735.82	4284495.20	106	445909.08	4283942.75
48	446702.74	4284483.91	107	445921.82	4283909.15
49	446672.52	4284470.75	108	445926.33	4283897.12
50	446662.75	4284488.77	109	445926.55	4283873.49
51	446617.26	4284478.11	110	445926.58	4283870.36
52	446626.88	4284461.36	111	445925.44	4283849.22
53	446538.53	4284434.03	112	445928.52	4283844.67
54	446540.28	4284427.94	113	445936.74	4283842.79
55	446535.25	4284422.96	114	445971.84	4283848.42
56	446374.69	4284392.02	115	445981.66	4283843.07
57	446370.82	4284386.01	116	445950.58	4283817.56
58	446374.73	4284371.21	117	445954.82	4283814.03
59	446367.39	4284367.12	118	445960.98	4283788.63

PROJEKSİYON : UTM 3

COĞRAFI VERİLERE İLİŞKİN DATUM : ITRF 96

DİLİM ORTA MERİDYENİ : 30

DİLİM GENİŞLİĞİ : 3

Nokta No	Y	X	Nokta No	Y	X
119	445978.47	4283773.31	178	445153.91	4283357.52
120	446002.90	4283764.38	179	445119.54	4283351.95
121	446025.75	4283743.10	180	445113.59	4283350.03
122	446034.67	4283726.34	181	445108.46	4283348.38
123	446032.31	4283725.08	182	445096.79	4283343.70
124	445938.89	4283652.98	183	445085.87	4283337.31
125	445912.25	4283632.42	184	445075.98	4283329.94
126	445908.08	4283623.82	185	445072.70	4283326.85
127	445892.99	4283629.71	186	445067.12	4283321.58
128	445881.32	4283631.01	187	445059.86	4283313.50
129	445867.14	4283632.60	188	445046.39	4283296.79
130	445823.55	4283637.48	189	445027.96	4283273.94
131	445796.36	4283581.76	190	445019.59	4283263.58
132	445801.68	4283553.58	191	445016.58	4283259.84
133	445814.11	4283530.88	192	444995.47	4283233.73
134	445786.94	4283533.58	193	444991.43	4283228.14
135	445750.98	4283536.47	194	444984.99	4283220.35
136	445740.11	4283514.60	195	444980.21	4283222.83
137	445733.43	4283517.19	196	444950.92	4283183.40
138	445728.79	4283491.27	197	444927.89	4283198.75
139	445717.20	4283471.59	198	444899.73	4283212.36
140	445707.71	4283438.92	199	444902.15	4283221.79
141	445705.94	4283434.30	200	444909.78	4283261.60
142	445677.90	4283445.60	201	444910.54	4283271.77
143	445674.38	4283423.73	202	444917.70	4283294.26
144	445677.05	4283397.34	203	444922.56	4283296.89
145	445677.69	4283382.81	204	444927.18	4283312.27
146	445691.44	4283358.97	205	444932.16	4283340.58
147	445661.55	4283340.71	206	444936.74	4283385.57
148	445654.22	4283369.75	207	444940.57	4283413.33
149	445643.99	4283368.59	208	444947.41	4283450.11
150	445595.79	4283346.58	209	444952.29	4283488.02
151	445573.29	4283321.93	210	444960.42	4283486.43
152	445538.93	4283343.98	211	444967.82	4283482.15
153	445512.77	4283350.79	212	444974.13	4283509.85
154	445481.85	4283312.12	213	444974.35	4283537.61
155	445470.27	4283307.24	214	444970.08	4283573.66
156	445444.41	4283294.64	215	444962.94	4283639.78
157	445461.91	4283276.48	216	444962.46	4283724.83
158	445476.44	4283260.11	217	444966.31	4283769.45
159	445461.65	4283249.85	218	444967.23	4283777.08
160	445421.65	4283212.26	219	444975.58	4283862.94
161	445411.92	4283218.09	220	444977.37	4283915.45
162	445372.24	4283220.54	221	444982.34	4283969.96
163	445344.89	4283214.24	222	444986.72	4283998.52
164	445302.47	4283235.84	223	444998.14	4284021.35
165	445276.22	4283245.32	224	445014.77	4284051.85
166	445270.82	4283248.92	225	445018.92	4284054.69
167	445272.06	4283295.46	226	445026.56	4284069.60
168	445245.39	4283320.29	227	445035.61	4284100.11
169	445236.99	4283328.11	228	445036.33	4284119.40
170	445222.58	4283338.91	229	445030.16	4284139.52
171	445208.46	4283346.49	230	445042.61	4284213.25
172	445205.77	4283347.35	231	445053.55	4284238.49
173	445200.38	4283349.04	232	445084.77	4284282.72
174	445191.71	4283351.79	233	445091.19	4284305.85
175	445179.60	4283354.74	234	445087.59	4284325.93
176	445168.69	4283356.46	235	445091.32	4284359.80
177	445160.48	4283357.08	236	445089.10	4284413.44

PROJEKSİYON : UTM 3

COĞRAFİ VERİLERE İLİŞKİN DATUM : ITRF 96

DİLİM ORTA MERİDYENİ : 30

DİLİM GENİŞLİĞİ : 3

Nokta No	Y	X
237	445104.84	4284410.88
238	445107.04	4284434.56
239	445154.10	4284426.30
240	445162.70	4284449.84
241	445178.72	4284491.49
242	445173.15	4284497.70
243	445036.35	4284541.70
244	445047.58	4284568.87
245	445059.18	4284614.60
246	445060.41	4284628.93
247	445048.50	4284656.60
248	444991.52	4284673.99
249	445034.05	4284745.40
250	445118.66	4284953.36
251	445104.47	4285036.04
252	445112.42	4285106.79
253	445107.59	4285147.22
254	445041.23	4285159.41
255	445052.51	4285200.24
256	444949.39	4285120.58
257	444934.14	4285220.45
258	444939.76	4285291.04
259	444950.46	4285311.75
260	444923.40	4285460.50
261	444862.50	4285557.58
262	444839.99	4285614.03
263	444773.32	4285622.76
264	444755.14	4285698.38
265	444695.49	4285721.70
266	444708.13	4285743.44
267	444718.60	4285785.20
268	444798.51	4285749.86
269	444930.22	4285714.41
270	444917.02	4285680.35
271	444919.67	4285650.58

PROJEKSİYON : UTM 3

COĞRAFI VERİLERE İLİŞKİN DATUM : ITRF 96

DİLİM ORTA MERİDYENİ : 30

DİLİM GENİŞLİĞİ : 3