

CUMHURBAŞKANI KARARI

**Karar Sayısı: 1551**

Kütahya İli, Merkez İlçesi, Enne, İnköy ve Parmakören mahalleleri sınırları içerisinde yer alan bazı alanların kentsel dönüşüm ve gelişim proje alanı ilan edilmesine ilişkin ekli Kararın yürürlüğe konulmasına, 5393 sayılı Belediye Kanununun 73 üncü maddesi gereğince karar verilmiştir.

17 Eylül 2019

Recep Tayyip ERDOĞAN
CUMHURBAŞKANI

**17/9/2019 TARİHLİ VE 1551 SAYILI
CUMHURBAŞKANI KARARININ EKİ**

KARAR

Kentsel dönüşüm ve gelişim proje alanı

MADDE 1- (1)Kütahya İli, Merkez İlçesi, Enne, İnköy ve Parmakören mahalleleri sınırları içerisinde bulunan ve ekli krokiler ile listelerde sınır ve koordinatları gösterilen alanlar, kentsel dönüşüm ve gelişim proje alanı ilan edilmiştir.

(2) Birinci fıkra kapsamında ilan edilen kentsel dönüşüm ve gelişim proje alanları içerisinde yer alan ve harca esas değer üzerinden belediyelere devredilen Hazineye ait taşınmazlar, kentsel dönüşüm ve gelişim amacına yönelik imar planı ve uygulaması yapılmadan satılamaz.

Yürürlük

MADDE 2- (1) Bu Karar yayımı tarihinde yürürlüğe girer.

Yürütme

MADDE 3- (1) Bu Karar hükümlerini Çevre ve Şehircilik Bakanı yürütür.

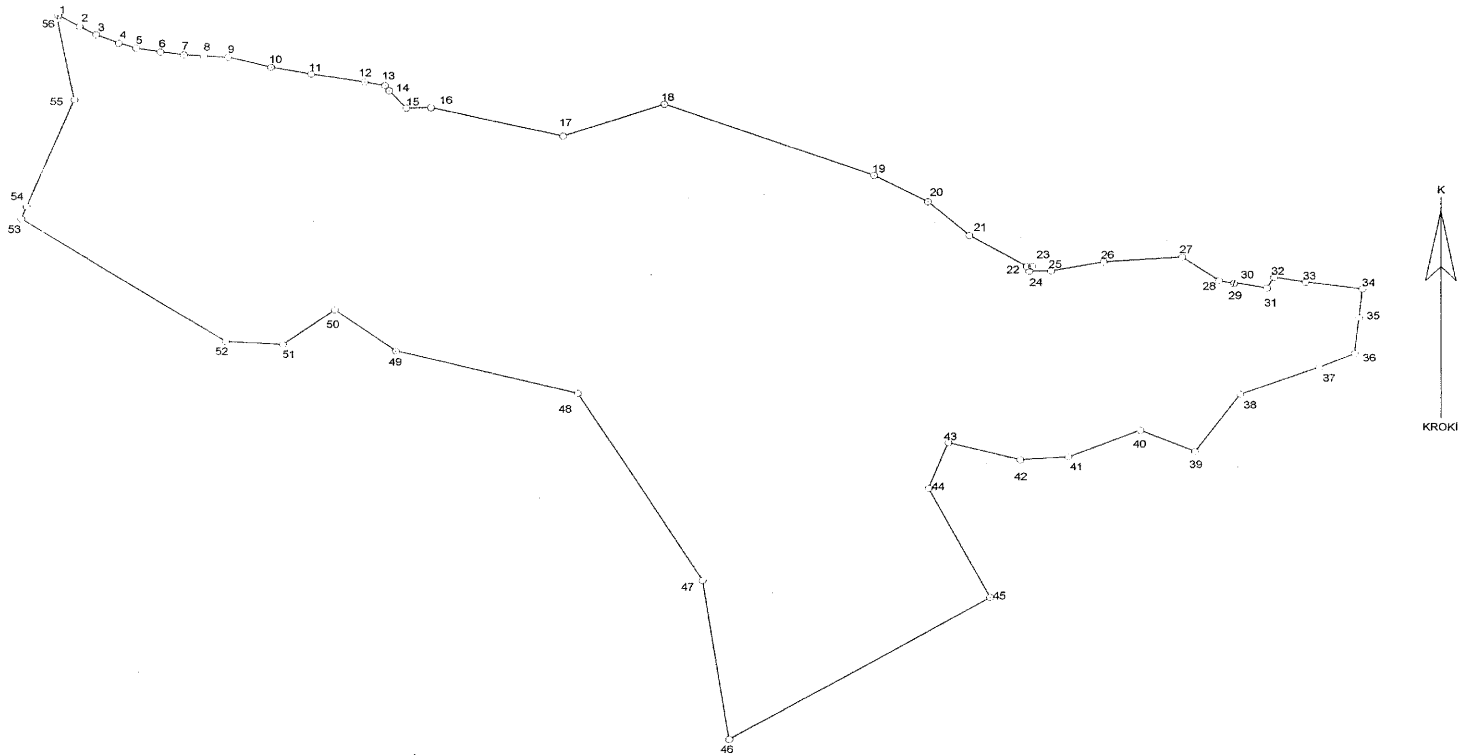

Alan büyüklüğü 150144.038 m2 ' dir.

KÜTAHYA İLİ MERKEZ ENNE MAHALLESİ ENNE KENTSEL DÖNÜŞÜM VE GELİŞİM PROJE ALANI SINIR KROKİSİ

Nokta No	Y	X
1	486831.549	4371206.832
2	486844.403	4371199.347
3	486854.418	4371194.017
4	486868.116	4371188.414
5	486878.673	4371185.045
6	486893.307	4371182.618
7	486907.445	4371180.638
8	486919.504	4371179.813
9	486934.039	4371179.114
10	486960.052	4371172.264
11	486984.384	4371167.610
12	487016.636	4371162.370
13	487028.834	4371160.081
14	487031.379	4371156.513
15	487041.714	4371144.757
16	487056.626	4371145.056
17	487136.654	4371126.445
18	487197.915	4371147.754
19	487324.785	4371100.541
20	487357.525	4371083.069
21	487382.609	4371080.903
22	487417.439	4371040.414
23	487420.544	4371040.626
24	487418.878	4371037.315
25	487431.990	4371037.888
26	487463.760	4371043.571
27	487511.038	4371046.793
28	487533.113	4371031.273
29	487542.212	4371029.303
30	487542.372	4371029.913
31	487562.082	4371026.423
32	487568.282	4371033.603
33	487585.212	4371030.413
34	487619.607	4371025.677
35	487617.635	4371006.648
36	487615.009	4370982.529
37	487593.407	4370973.337
38	487545.808	4370954.965
39	487518.706	4370915.864
40	487485.844	4370930.362
41	487442.351	4370911.998
42	487413.355	4370910.065
43	487369.861	4370921.863
44	487357.780	4370890.734
45	487394.991	4370817.761
46	487236.964	4370722.559
47	487221.017	4370828.876
48	487145.693	4370954.799
49	487035.509	4370983.312
50	486998.781	4371010.858
51	486967.369	4370987.661
52	486933.058	4370969.594
53	486809.392	4371071.156
54	486812.656	4371079.153
55	486841.307	4371150.102
56	486830.971	4371204.340

Proje katıyon : UTM 3 Derece - Datum: ITRF - Dilim No: 30

KÜTAHYA İLİ MERKEZ ENNE MAHALLESİ ENNE KENTSEL DÖNÜŞÜM VE GELİŞİM PROJE ALANI KOORDİNAT LİSTESİ

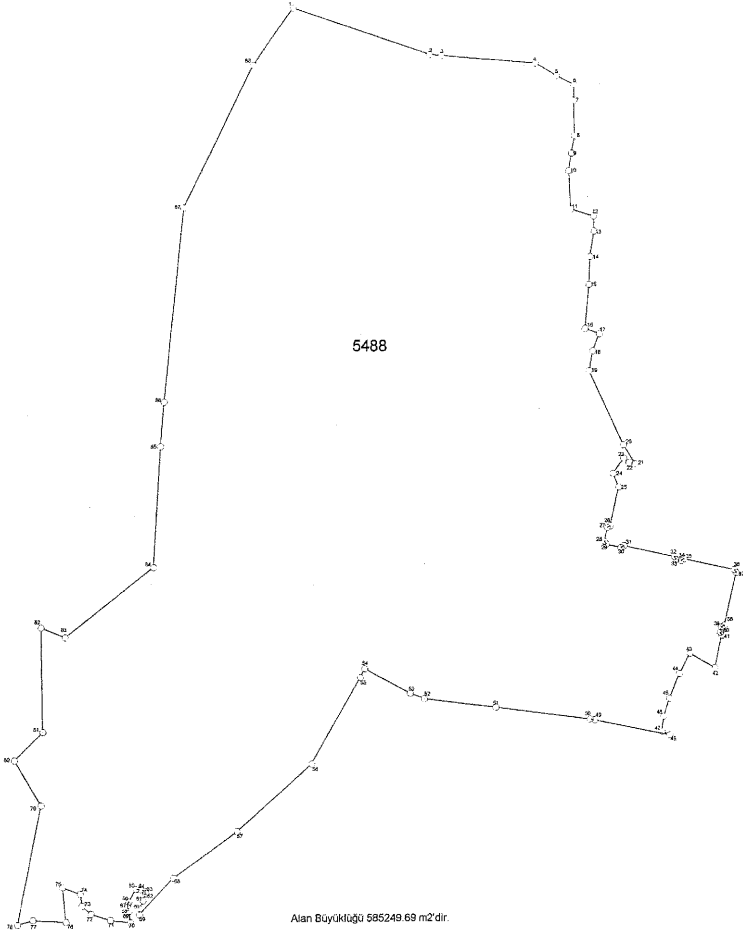

KÜTAHYA İLİ MERKEZ İNKÖY MAHALLESİ 5488 PARSEL KENTSEL DÖNÜŞÜM VE GELİŞİM PROJE ALANI SINIR KROKİSİ

Nokta No	Y	X
1	499672.873	4370815.570
2	499851.045	4370754.112
3	499866.135	4370752.832
4	499888.995	4370742.142
5	500016.415	4370725.822
6	500039.403	4370714.053
7	500039.391	4370693.934
8	500039.929	4370648.424
9	500035.878	4370626.315
10	500032.112	4370603.787
11	500034.579	4370554.243
12	500064.526	4370544.912
13	500064.815	4370525.688
14	500059.497	4370492.825
15	500057.957	4370456.856
16	500052.726	4370400.316
17	500071.190	4370393.343
18	500062.501	4370371.264
19	500057.634	4370345.348
20	500101.851	4370249.199
21	500116.590	4370224.498
22	500109.033	4370226.203
23	500102.285	4370231.940
24	500088.820	4370212.354
25	500095.878	4370194.855
26	500084.352	4370144.634
27	500080.766	4370142.367
28	500076.806	4370124.808
29	500079.072	4370121.222
30	500098.582	4370116.822
31	500102.169	4370119.089
32	500167.040	4370104.459
33	500169.306	4370100.872
34	500176.135	4370099.333
35	500179.721	4370101.599
36	500245.080	4370086.859
37	500247.346	4370083.273
38	500231.947	4370014.988
39	500228.360	4370012.721
40	500226.820	4370005.893
41	500229.087	4370002.306
42	500219.633	4369980.357
43	500186.871	4369979.446
44	500172.945	4369953.433
45	500159.832	4369921.528
46	500152.003	4369898.514
47	500149.584	4369879.078
48	500159.808	4369874.156
49	500062.779	4369894.337
50	500056.730	4369895.364
51	499933.517	4369911.700
52	499840.559	4369923.363
53	499821.596	4369930.428
54	499762.799	4369982.452
55	499756.890	4369950.912
56	499693.060	4369839.985
57	499596.696	4369752.916
58	499514.275	4369693.424
59	499470.063	4369646.520

Nokta No	Y	X
60	499470.190	4369653.920
61	499474.730	4369664.360
62	499477.890	4369673.670
63	499477.550	4369676.680
64	499471.480	4369678.640
65	499465.500	4369679.280
66	499456.200	4369662.820
67	499454.610	4369659.410
68	499454.690	4369656.260
69	499456.310	4369650.880
70	499458.460	4369636.290
71	499431.604	4369639.339
72	499406.685	4369647.362
73	499394.783	4369657.750
74	499392.959	4369673.149
75	499369.813	4369681.674
76	499374.126	4369667.130
77	499330.800	4369639.575
78	499310.791	4369633.720
79	499342.169	4369787.488
80	499307.575	4369845.754
81	499344.809	4369882.457
82	499343.200	4370017.336
83	499374.630	4370004.599
84	499490.259	4370094.888
85	499499.886	4370250.831
86	499504.900	4370308.530
87	499531.291	4370559.216
88	499621.644	4370742.110

Proje Katyon : UTM 3 Derece - Datum : ITRF - Dilim No: 30

KÜTAHYA İLİ MERKEZ İNKÖY MAHALLESİ 5488 PARSEL KENTSEL DÖNÜŞÜM VE GELİŞİM PROJE ALANI

SINIR KROKİSİNE AİT KOORDİNAT LİSTESİ

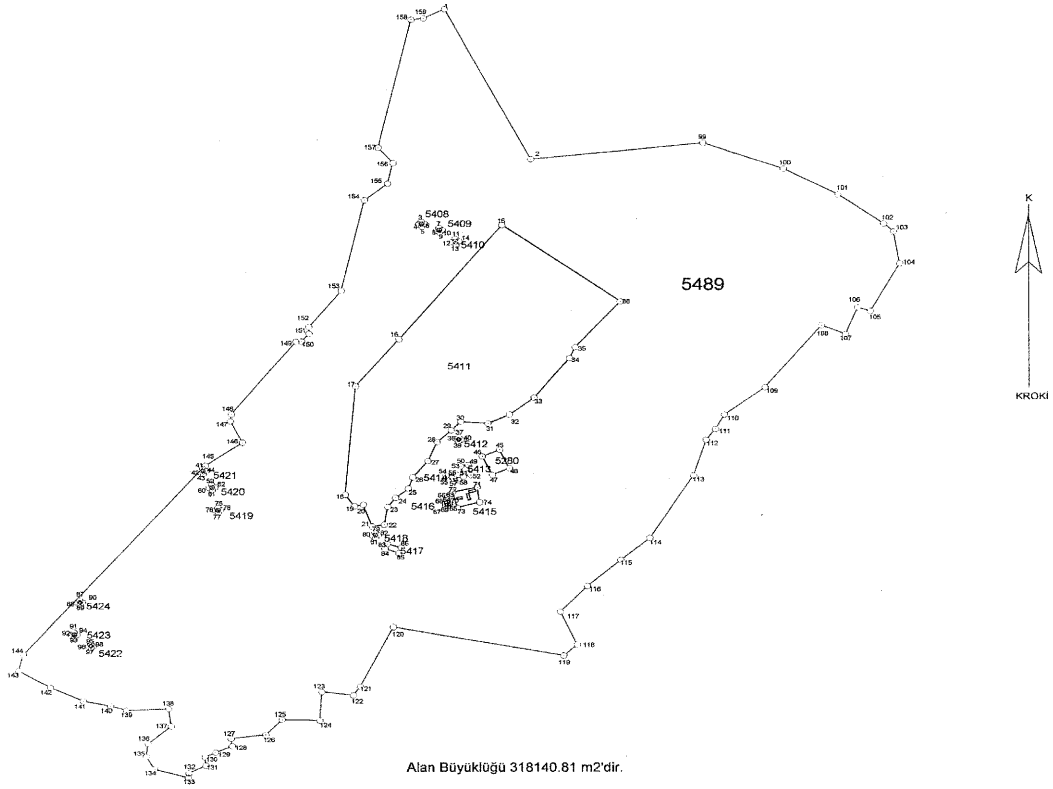

KÜTAHYA İLİ MERKEZ İNKÖY MAHALLESİ 5489 PARSEL KENTSEL DÖNÜŞÜM VE GELİŞİM PROJE ALANI SINIR KROKİSİ

KOORDINAT LİSTESİ

Nokta No	Y	X
1	500943.270	4370094.271
2	500733.813	4369757.979
3	500618.138	4369777.957
4	500615.434	4369774.338
5	500618.926	4369771.672
6	500621.864	4369776.135
7	500637.161	4369770.120
8	500634.423	4369768.849
9	500337.991	4369764.277
10	500640.571	4369767.537
11	500654.059	4369757.084
12	500651.047	4369753.172
13	500655.082	4369750.097
14	500658.128	4369754.123
15	500703.248	4369773.592
16	500694.498	4369935.821
17	500548.710	4369978.404
18	500537.372	4369448.364
19	500556.231	4369943.348
20	500565.544	4369408.013
21	500578.278	4369910.197
22	500581.983	4369943.819
23	500590.134	4369842.754
24	500603.712	4369943.889
25	500609.399	4369947.507
26	500624.964	4369947.566
27	500634.423	43699510.822
28	500649.336	43699525.145
29	500659.426	43699535.787
30	500688.053	43699533.635
31	500710.804	43699544.437
32	500736.928	43699564.988
33	500774.290	43699613.222
34	500780.179	43699605.586
35	500827.246	43699621.152
36	500857.697	43699614.775
37	500858.829	43699513.851
38	500860.911	4369478.224
39	500884.110	4369474.859
40	500887.592	4369471.846
41	500900.951	4369475.459
42	500700.214	43699501.461
43	500822.014	4369493.181
44	500892.374	4369470.411
45	500710.574	4369478.701
46	500660.962	4369482.967
47	500656.134	4369481.090
48	500661.890	4369488.534
49	500669.713	4369470.194
50	500655.180	4369470.588
51	500643.863	4369469.276
52	500644.328	4369464.774
53	500651.741	4369468.070
54	500652.584	4369463.000
55	500656.826	4369464.037
56	500396.345	4369458.222

Nokta No	Y	X
60	500393.390	4369454.735
61	500397.873	4369451.761
62	500399.873	4369455.452
63	500649.972	4369437.468
64	500645.236	4369436.549
65	500645.118	4369435.699
66	500642.805	4369435.424
67	500643.296	4369432.992
68	500645.435	4369433.278
69	500645.726	4369432.528
70	500650.801	4369433.434
71	500676.850	4369455.562
72	500630.604	4369449.563
73	500655.500	4369430.708
74	500679.131	4369437.310
75	500402.701	4369430.626
76	500400.107	4369427.408
77	500403.310	4369424.918
78	500405.918	4369428.005
79	500568.416	4369400.859
80	500565.571	4369397.378
81	500569.085	4369394.352
82	500571.987	4369397.917
83	500581.585	4369387.205
84	500578.870	4369381.160
85	500575.714	4369383.774
86	500595.922	4369382.674
87	500257.078	4369310.019
88	500254.826	43692516.318
89	500257.525	4369313.982
90	500259.778	4369316.645
91	500250.640	4369260.206
92	500248.000	4369276.920
93	500251.224	4369274.229
94	500263.791	4369277.359
95	500268.381	4369285.789
96	500265.250	4369283.420
97	500268.739	4369261.332
98	500270.801	4369265.573
99	500915.682	4369873.753
100	501000.472	4369842.250
101	501057.851	4369810.970
102	501105.991	4369775.991
103	501118.151	4369766.178
104	501122.615	4369727.878
105	501091.002	4369870.454
106	501078.585	4369674.709
107	501065.893	4369842.459
108	501040.334	4369953.137
109	500950.716	4369577.689
110	500937.729	4369554.434
111	500928.185	4369526.839
112	500918.443	4369513.653
113	500904.774	4369469.803
114	500858.424	4369394.193
115	500827.533	4369897.687
116	500762.271	4369935.880
117	500763.753	4369934.985
118	500781.150	4369264.951

Nokta No	Y	X
119	500767.047	4369251.866
120	500697.318	4369298.122
121	500552.273	4369214.284
122	500544.806	4369203.432
123	500511.636	4369207.852
124	500508.646	4369172.872
125	500469.817	4369173.816
126	500452.589	4369155.533
127	500418.630	4369150.988
128	500416.995	4369141.590
129	500390.360	4369133.777
130	500385.350	4369128.057
131	500389.049	4369116.100
132	500371.227	4369108.919
133	500370.441	4369103.399
134	500354.925	4369113.566
135	500326.249	4369128.622
136	500328.270	4369144.952
137	500322.505	4369166.131
138	500350.050	4369196.826
139	500305.447	4369194.724
140	500289.736	4369190.527
141	500280.102	4369196.750
142	500225.593	4369213.345
143	500192.261	4369233.425
144	500197.658	4369233.400
145	500389.710	4369461.917
146	500428.123	4369510.070
147	500415.588	4369536.167
148	500417.487	4369544.625
149	500485.970	4369632.829
150	500462.142	4369632.984
151	500469.670	4369680.594
152	500533.895	4369694.715
153	500555.399	4369693.412
154	500528.767	4369682.294
155	500586.472	4369648.800
156	500572.853	4369697.637
157	500607.568	4370021.448
158	500602.932	4370023.072

Projeksiyon : UTM 3 Derece - Datum : ITRF - Dilim No: 30

KÜTAHYA İLİ MERKEZ İNKÖY MAHALLESİ 5489 PARSEL KENTSEL DÖNÜŞÜM VE GELİŞİM PROJE ALANI
SINIR KROKİSİNE AİT KOORDINAT LİSTESİ

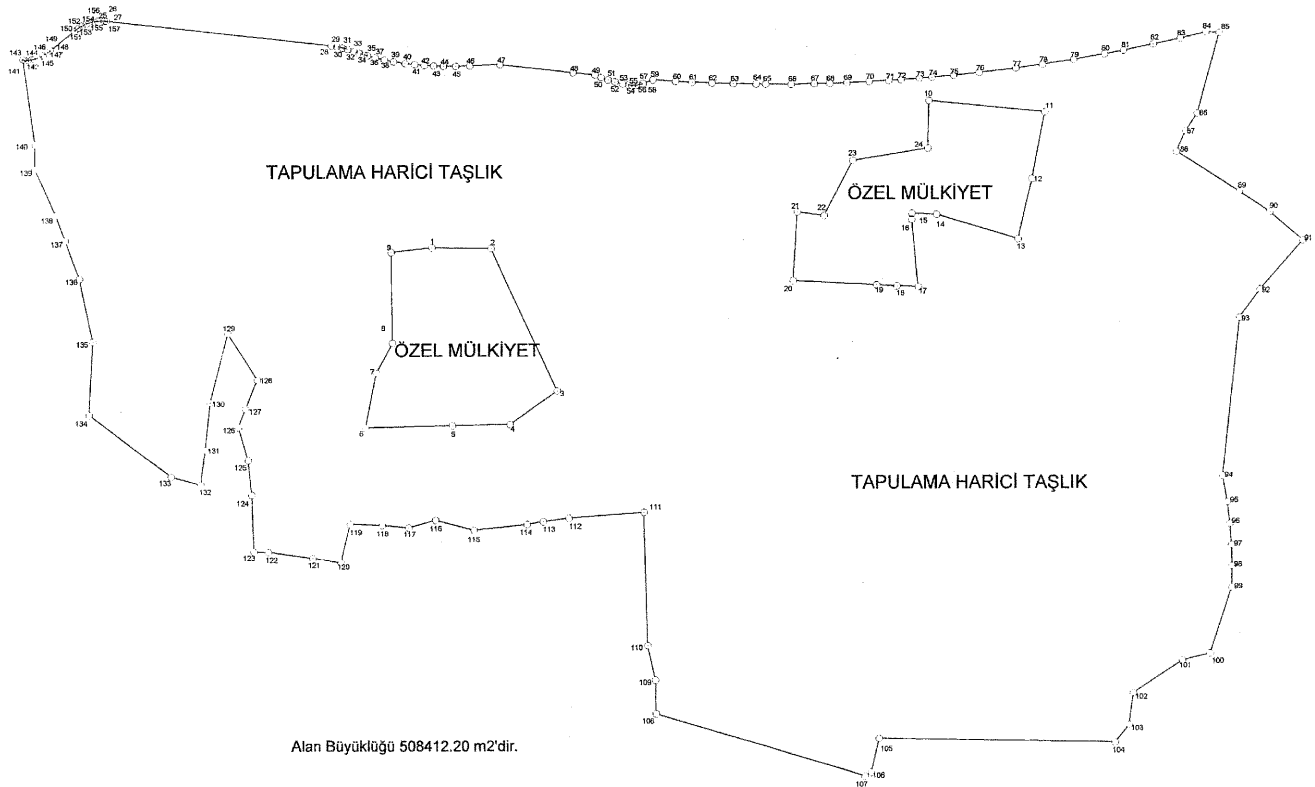

KÜTAHYA İLİ MERKEZ PARMAKÖREN MAHALLESİ UYDUKENT KUZEYİ KENTSEL DÖNÜŞÜM VE GELİŞİM PROJE ALANI SINIR KROKİSİ

Nokta No	Y	X
1	494898.082	4372405.157
2	494950.671	4372404.611
3	495011.585	4372272.271
4	494987.988	4372241.172
5	494914.868	4372240.113
6	494834.754	4372238.180
7	494844.638	4372289.011
8	494859.763	4372316.949
9	494858.805	4372400.925
10	495355.511	4372540.256
11	495462.162	4372529.573
12	495450.407	4372468.199
13	495437.333	4372412.993
14	495382.421	4372436.444
15	495335.458	4372436.457
16	495339.297	4372430.926
17	495345.204	4372369.683
18	495325.510	4372370.406
19	495306.666	4372371.355
20	495229.765	4372375.236
21	495233.795	4372437.741
22	495258.329	4372434.507
23	495294.926	4372484.886
24	495354.392	4372498.059
25	494591.892	4372615.193
26	494594.536	4372615.112
27	494596.359	4372614.948
28	494603.773	4372591.215
29	494608.824	4372580.515
30	494813.279	4372589.591
31	494814.583	4372589.272
32	494818.977	4372588.023
33	494824.808	4372588.980
34	494829.572	4372584.305
35	494834.071	4372582.841
36	494837.160	4372591.901
37	494844.332	4372579.920
38	494852.673	4372579.960
39	494861.250	4372576.319
40	494871.756	4372574.714
41	494880.622	4372573.649
42	494889.463	4372572.846
43	494897.905	4372572.319
44	494907.003	4372572.013
45	494918.318	4372572.009
46	494931.419	4372572.441
47	494899.332	4372573.482
48	495026.886	4372566.764
49	495047.076	4372563.584
50	495052.589	4372561.348
51	495058.967	4372560.123
52	495065.465	4372557.239
53	495072.808	4372555.549
54	495077.830	4372554.523
55	495081.143	4372554.084
56	495084.759	4372554.135
57	495087.648	4372554.575
58	495091.334	4372555.682
59	495100.448	4372556.035

Nokta No	Y	X
60	495121.253	4372557.736
61	495136.514	4372566.952
62	495155.066	4372566.191
63	495174.741	4372555.613
64	495195.905	4372555.256
65	495204.780	4372555.187
66	495228.312	4372555.237
67	495249.547	4372555.573
68	495263.997	4372556.908
69	495279.831	4372556.519
70	495300.260	4372557.488
71	495318.430	4372558.557
72	495329.642	4372559.317
73	495346.678	4372560.601
74	495358.262	4372561.610
75	495378.250	4372563.510
76	495401.863	4372566.074
77	495435.742	4372570.359
78	495460.300	4372573.914
79	495488.933	4372578.541
80	495517.233	4372583.627
81	495534.843	4372587.051
82	495562.119	4372592.750
83	495587.072	4372598.961
84	495610.445	4372604.047
85	495622.758	4372603.753
86	495622.435	4372528.485
87	495591.439	4372512.030
88	495583.197	4372493.198
89	495640.843	4372456.332
90	495668.794	4372437.781
91	495669.209	4372411.836
92	495659.591	4372387.222
93	495640.769	4372340.905
94	495624.880	4372193.402
95	495629.058	4372188.935
96	495631.194	4372188.981
97	495632.688	4372129.127
98	495633.223	4372106.532
99	495632.726	4372089.263
100	495612.704	4372028.114
101	495587.124	4372021.444
102	495541.839	4371991.781
103	495538.149	4371962.428
104	495524.953	4371945.950
105	495307.695	4371949.633
106	495300.358	4371918.164
107	495294.439	4371914.749
108	495101.817	4371972.931
109	495101.128	4372003.956
110	495094.226	4372036.721
111	495091.148	4372159.550
112	495022.133	4372154.225
113	494988.336	4372151.101
114	494983.326	4372148.453
115	494934.275	4372143.233
116	494988.817	4372152.419
117	494874.235	4372145.609
118	494849.699	4372147.831

Nokta No	Y	X
119	494820.177	4372149.055
120	494811.528	4372113.047
121	494785.465	4372116.896
122	494744.549	4372123.666
123	494731.438	4372123.007
124	494729.597	4372175.762
125	494726.343	4372208.177
126	494717.512	4372238.871
127	494724.003	4372255.522
128	494734.893	4372282.663
129	494708.009	4372326.903
130	494691.644	4372261.383
131	494687.094	4372217.757
132	494682.788	4372185.202
133	494655.430	4372192.810
134	494679.837	4372250.263
135	494593.363	4372318.555
136	494571.205	4372377.486
137	494567.923	4372410.013
138	494549.399	4372435.223
139	494530.182	4372477.517
140	494530.418	4372499.773
141	494519.254	4372579.073
142	494521.316	4372578.157
143	494523.678	4372578.335
144	494527.361	4372578.902
145	494528.830	4372579.485
146	494533.859	4372580.811
147	494537.916	4372582.664
148	494542.097	4372585.211
149	494544.789	4372587.267
150	494565.803	4372605.629
151	494569.780	4372607.982
152	494570.951	4372608.812
153	494573.970	4372610.623
154	494577.810	4372613.428
155	494580.711	4372613.465
156	494584.914	4372614.519
157	494588.356	4372615.014

Projeksiyon : UTM 3 Derece - Datum : ITRF - Dilim No: 30

KÜTAHYA İLİ MERKEZ PARMAKÖREN MAHALLESİ UYDUKENT KUZEYİ KENTSEL DÖNÜŞÜM VE GELİŞİM PROJE ALANI
SINIR KROKİSİNE AİT KOORDİNAT LİSTESİ