

CUMHURBAŞKANI KARARI

**Karar Sayısı: 4370**

Mardin İli, Midyat İlçesi, Acırlı, Akçakaya, Bağlar, Işıklar ve Ulucami mahalleleri sınırları içerisinde yer alan bazı alanların kentsel dönüşüm ve gelişim proje alanı ilan edilmesine ilişkin ekli Kararın yürürlüğe konulmasına, 5393 sayılı Belediye Kanununun 73 üncü maddesi gereğince karar verilmiştir.

6 Ağustos 2021

Recep Tayyip ERDOĞAN
CUMHURBAŞKANI

**6/8/2021 TARİHLİ VE 4370 SAYILI
CUMHURBAŞKANI KARARININ EKİ**

KARAR

Kentsel dönüşüm ve gelişim proje alanı

MADDE 1- (1) Mardin İli, Midyat İlçesi, Acırlı, Akçakaya, Bağlar, Işıklar ve Ulucami mahalleleri sınırları içerisinde yer alan ve ekli krokiler ile listelerde sınır ve koordinatları gösterilen alanlar, kentsel dönüşüm ve gelişim proje alanı ilan edilmiştir.

(2) Birinci fıkra kapsamında ilan edilen kentsel dönüşüm ve gelişim proje alanları içerisinde yer alan ve harca esas değer üzerinden belediyelere devredilen Hazineye ait taşınmazlar, kentsel dönüşüm ve gelişim amacına yönelik imar planı ve uygulaması yapılmadan satılamaz.

Yürürlük

MADDE 2- (1) Bu Karar yayımı tarihinde yürürlüğe girer.

Yürütme

MADDE 3- (1) Bu Karar hükümlerini Çevre ve Şehircilik Bakanı yürütür.

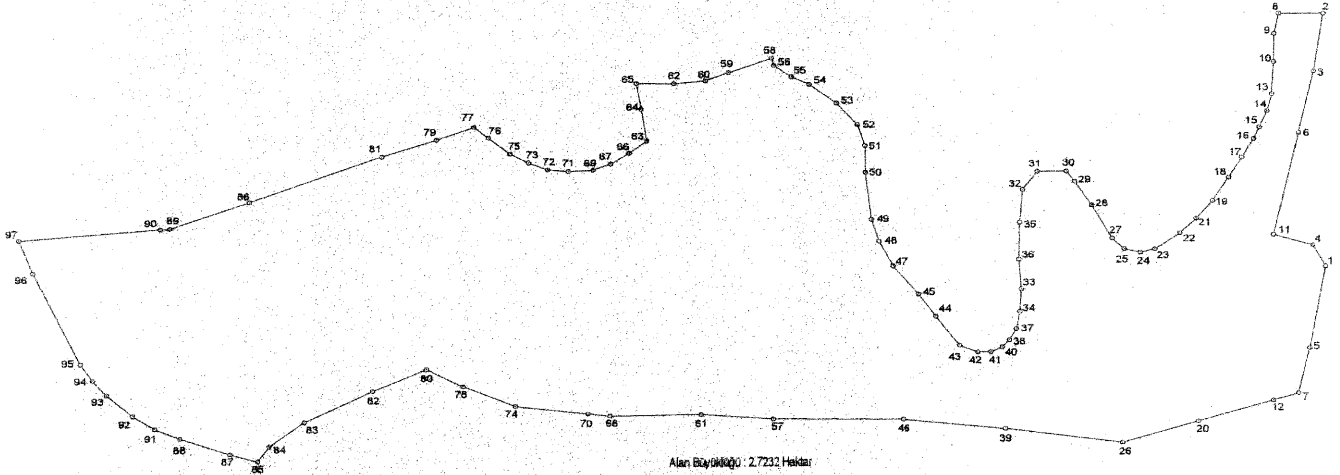

MARDIN İLİ , MİDYAT İLÇESİ
ACIRLI MAHALLESİ 110 ADA 12 PARSEL
KENTSEL DÖNÜŞÜM VE GELİŞİM PROJE ALANI
SINIR KROKİSİ

MARDİN İLİ , MİDYAT İLÇESİ
ACIRLI MAHALLESİ 110 ADA 12 PARSEL
KENTSEL DÖNÜŞÜM VE GELİŞİM PROJE ALANI
KOORDİNAT LİSTESİ

NoktaNo	Y	X
1	439713.160	4145821.828
2	439712.484	4145904.293
3	439709.777	4145885.492
4	439709.580	4145828.652
5	439708.730	4145795.429
6	439705.499	4145865.690
7	439705.446	4145780.747
8	439699.842	4145904.376
9	439698.572	4145897.788
10	439698.446	4145888.574
11	439698.340	4145832.173
12	439698.279	4145778.459
13	439697.883	4145878.094
14	439696.559	4145872.671
15	439694.363	4145867.436
16	439692.759	4145863.640
17	439689.394	4145857.615
18	439685.731	4145851.077
19	439681.223	4145843.518
20	439677.132	4145771.767
21	439676.578	4145837.594
22	439672.001	4145832.821
23	439664.880	4145827.734
24	439660.799	4145826.545
25	439656.260	4145827.836
26	439655.814	4145765.004
27	439652.856	4145831.318
28	439647.144	4145842.274
29	439642.380	4145850.075
30	439640.079	4145853.362
31	439631.870	4145853.416
32	439627.676	4145847.467
33	439627.228	4145814.853
34	439626.834	4145807.585
35	439626.788	4145836.584
36	439626.593	4145824.511
37	439625.820	4145801.951
38	439623.848	4145798.345
39	439622.713	4145769.710
40	439621.819	4145796.091
41	439618.608	4145794.626
42	439614.945	4145794.570
43	439609.762	4145796.711
44	439603.125	4145806.188
45	439598.257	4145813.422
46	439593.772	4145772.903
47	439590.954	4145822.617
48	439587.028	4145830.793
49	439584.925	4145837.920
50	439583.290	4145853.343
51	439583.173	4145862.222
52	439581.002	4145869.011
53	439575.106	4145876.079
54	439567.412	4145882.195
55	439562.409	4145884.629
56	439557.406	4145888.348
57	439556.858	4145773.284
58	439556.729	4145890.646
59	439544.657	4145886.106

NoktaNo	Y	X
60	439538.031	4145883.471
61	439536.494	4145774.889
62	439529.242	4145882.660
63	439521.450	4145864.097
64	439519.873	4145874.576
65	439518.626	4145882.795
66	439516.428	4145860.143
67	439511.187	4145856.670
68	439510.618	4145774.601
69	439506.257	4145854.698
70	439504.424	4145775.409
71	439499.308	4145854.309
72	439493.392	4145854.933
73	439488.040	4145857.234
74	439483.850	4145778.095
75	439482.734	4145860.239
76	439476.677	4145865.497
77	439472.554	4145869.034
78	439469.147	4145784.558
79	439462.032	4145864.950
80	439458.761	4145790.206
81	439446.474	4145859.568
82	439443.440	4145783.240
83	439424.126	4145773.340
84	439414.129	4145765.584
85	439410.957	4145760.858
86	439409.043	4145844.957
87	439403.116	4145763.208
88	439388.986	4145768.344
89	439386.605	4145836.404
90	439383.915	4145836.189
91	439381.866	4145771.584
92	439375.763	4145775.841
93	439368.277	4145782.690
94	439364.398	4145787.369
95	439360.950	4145792.716
96	439347.602	4145822.285
97	439343.779	4145832.934

Projeksiyon : UTM 3 Derece
Coğrafi Verilere İlişkin Datum : ITRF 96 (GRS 80 Elipsoidi)
Dilim Orta Meridyeni : 42 Derece
Dilim Geniğiği : 3 Derece

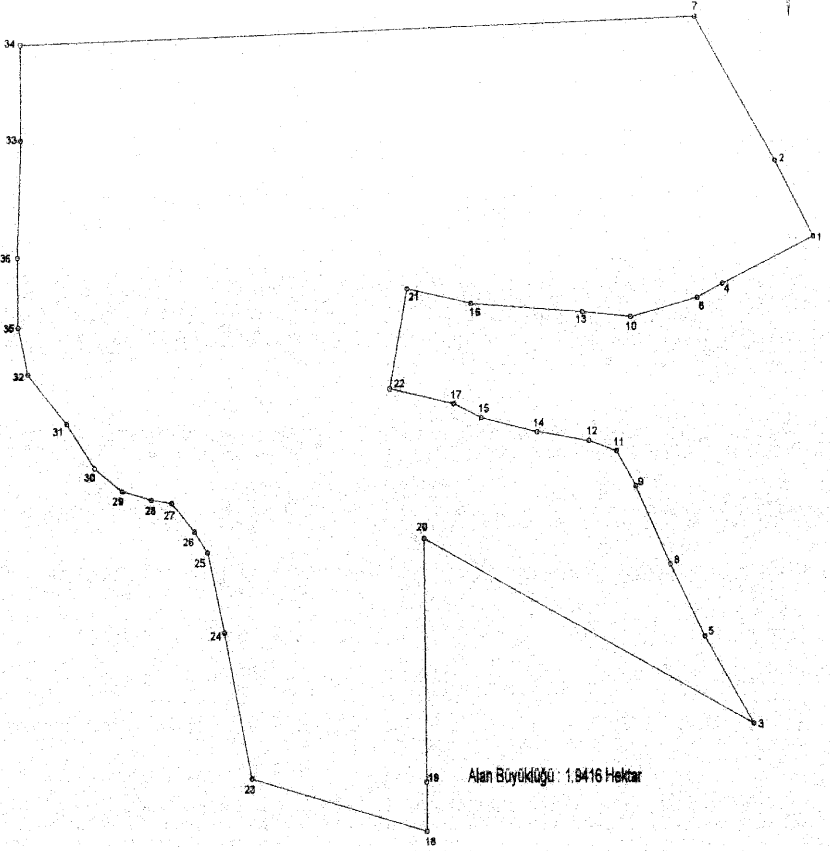

MARDİN İLİ , MİDYAT İLÇESİ
ACIRLI MAHALLESİ 111 ADA 127 PARSEL
KENTSEL DÖNÜŞÜM VE GELİŞİM PROJE ALANI
SINIR KROKİSİ

MARDIN İLİ , MİDYAT İLÇESİ
ACIRLI MAHALLESİ 111 ADA 127 PARSEL
KENTSEL DÖNÜŞÜM VE GELİŞİM PROJE ALANI
KOORDİNAT LİSTESİ

NoktaNo	Y	X
1	439051.063	4145653.376
2	439041.782	4145669.516
3	439036.303	4145549.846
4	439029.033	4145643.356
5	439024.463	4145568.346
6	439022.873	4145640.356
7	439022.423	4145700.064
8	439016.123	4145583.676
9	439007.863	4145600.306
10	439006.733	4145636.256
11	439003.203	4145607.766
12	438996.563	4145609.876
13	438995.013	4145637.286
14	438984.073	4145611.766
15	438970.463	4145614.686
16	438968.023	4145638.976
17	438963.793	4145617.666
18	438957.086	4145526.791
19	438956.999	4145537.220
20	438956.513	4145589.006
21	438952.533	4145642.056
22	438948.293	4145620.746
23	438914.702	4145537.751
24	438908.210	4145568.759
25	438904.148	4145585.810
26	438901.061	4145590.223
27	438895.523	4145596.252
28	438890.515	4145596.969
29	438883.539	4145598.777
30	438876.942	4145603.591
31	438870.286	4145612.943
32	438860.906	4145623.417
33	438859.239	4145673.114
34	438859.129	4145693.413
35	438858.557	4145633.342
36	438858.433	4145648.210

Projeksiyon : UTM 3 Derece
Coğrafi Verilere İlişkin Datum : ITRF 96 (GRS 80 Elipsoidi)
Diim Orta Meridyeni : 42 Derece
Diim Genişliği : 3 Derece

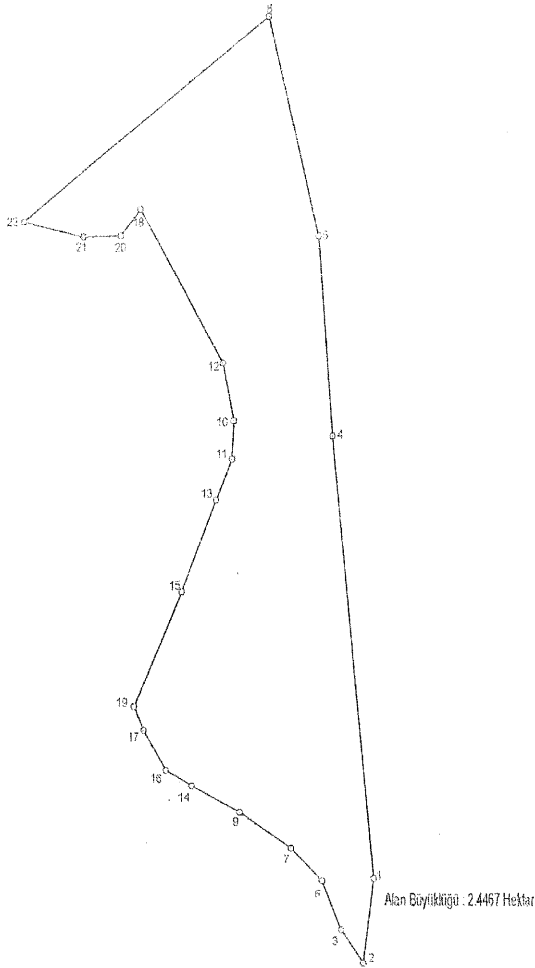
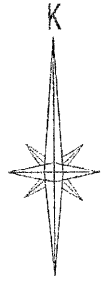

MARDİN İLİ , MİDYAT İLÇESİ
AKÇAKAYA MAHALLESİ 403 ADA 32 PARSEL
KENTSEL DÖNÜŞÜM VE GELİŞİM PROJE ALANI
SINIR KROKİSİ

MARDİN İLİ , MİDYAT İLÇESİ
AKÇAKAYA MAHALLESİ 403 ADA 32 PARSEL
KENTSEL DÖNÜŞÜM VE GELİŞİM PROJE ALANI
KOORDİNAT LİSTESİ

NoktaNo	Y	X
1	445710.750	4143004.400
2	445705.710	4142970.220
3	445695.320	4142983.560
4	445692.750	4143183.820
5	445686.850	4143264.400
6	445686.540	4143003.220
7	445672.310	4143016.650
8	445664.230	4143354.250
9	445648.420	4143031.420
10	445646.790	4143190.200
11	445645.880	4143174.490
12	445641.850	4143213.640
13	445638.220	4143157.620
14	445625.800	4143042.190
15	445621.590	4143120.550
16	445613.600	4143048.310
17	445603.100	4143064.570
18	445603.080	4143275.670
19	445598.690	4143074.070
20	445593.840	4143264.870
21	445576.190	4143264.410
22	445548.290	4143270.670

Projeksiyon : UTM 3 Derece
Coğrafi Verilere İlişkin Datum : European 1950 (ED-50)
Dilim Orta Meridyeni : 42 Derece
Dilim Geniřliđi : 3 Derece

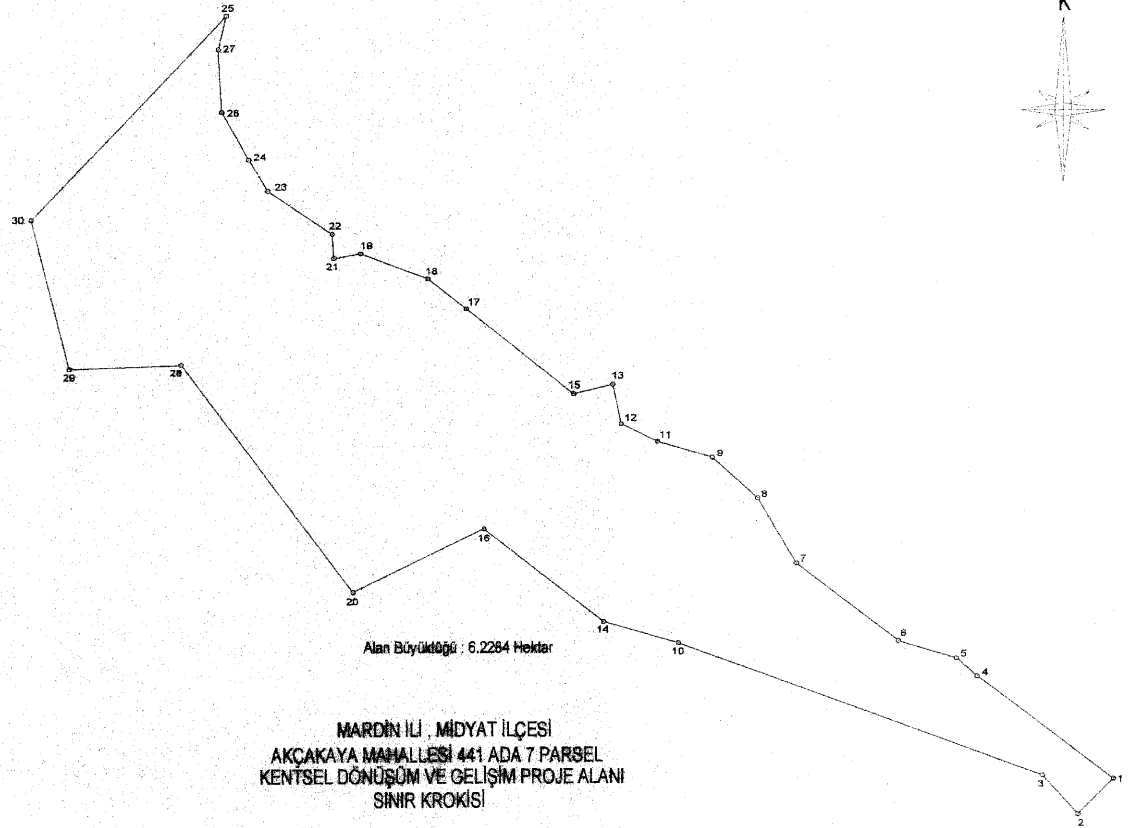

Alan Büyüklüğü : 6.2264 Hektar

MARDIN İLİ , MİDYAT İLÇESİ
AKÇAKAYA MAHALLESİ 441 ADA 7 PARSEL
KENTSEL DÖNÜŞÜM VE GELİŞİM PROJE ALANI
SINIR KROKİSİ

MARDİN İLİ , MIDYAT İLÇESİ
AKÇAKAYA MAHALLESİ 441 ADA 7 PARSEL
KENTSEL DÖNÜŞÜM VE GELİŞİM PROJE ALANI
KOORDİNAT LİSTESİ

NoktaNo	Y	X
1	446231.590	4143023.550
2	446213.220	4143002.900
3	446194.980	4143025.610
4	446161.540	4143084.060
5	446150.980	4143094.920
6	446121.410	4143105.200
7	446069.460	4143150.880
8	446049.630	4143189.050
9	446026.320	4143213.050
10	446009.100	4143104.510
11	445998.270	4143222.560
12	445979.560	4143233.040
13	445975.420	4143256.130
14	445970.710	4143117.120
15	445955.310	4143250.660
16	445909.390	4143171.430
17	445900.250	4143300.490
18	445880.670	4143318.200
19	445846.120	4143333.030
20	445842.310	4143134.450
21	445832.360	4143330.340
22	445831.540	4143344.520
23	445798.660	4143369.700
24	445788.750	4143387.900
25	445776.980	4143471.690
26	445774.900	4143415.920
27	445773.000	4143452.380
28	445754.330	4143267.830
29	445696.980	4143265.370
30	445677.500	4143353.000

Projeksiyon : UTM 3 Derece
Coğrafi Verilere İlişkin Datum : Europan 1950 (ED-50)
Dilim Orta Meridyeni : 42 Derece
Dilim Geniřliđi : 3 Derece

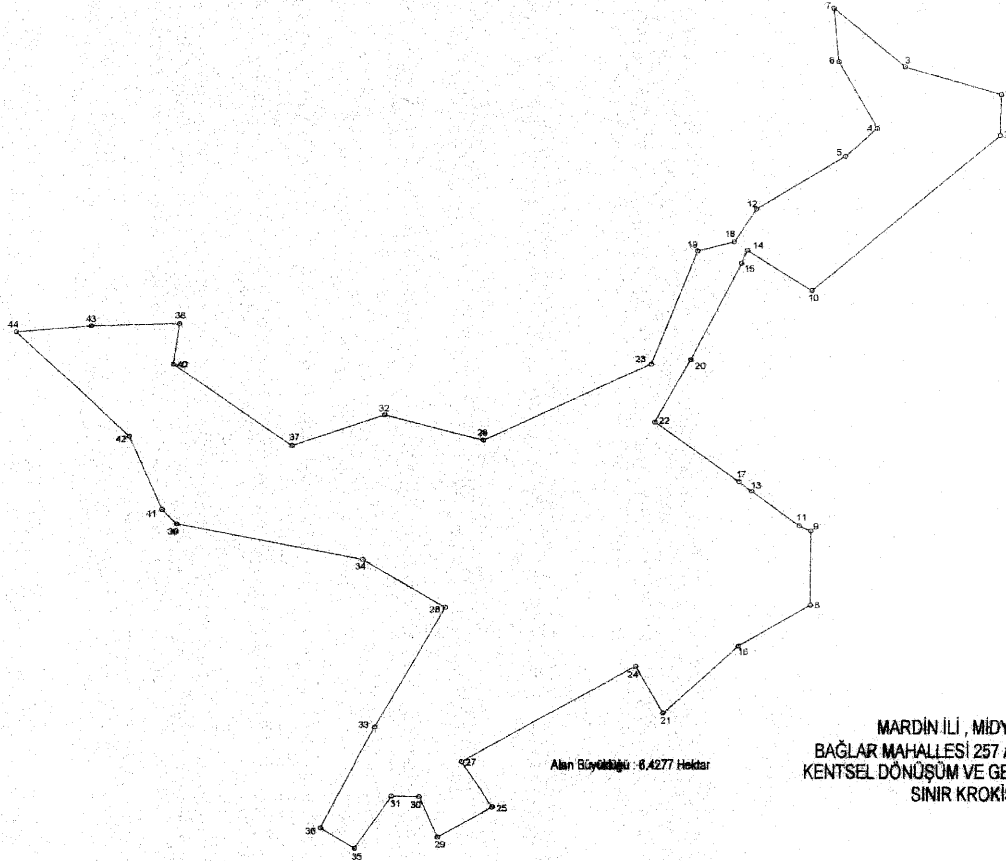
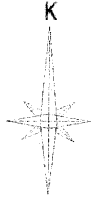

Alan Büyüklüğü : 8.4277 Hektar

MARDIN İLİ , MİDYAT İLÇESİ
BAĞLAR MAHALLESİ 257 ADA 79 PARSEL
KENTSEL DÖNÜŞÜM VE GELİŞİM PROJE ALANI
SINIR KROKİSİ

MARDİN İLİ , MIDYAT İLÇESİ
BAĞLAR MAHALLESİ 257 ADA 79 PARSEL
KENTSEL DÖNÜŞÜM VE GELİŞİM PROJE ALANI
KOORDİNAT LİSTESİ

NoktaNo	Y	X
1	440812.510	4146396.490
2	440812.140	4146371.190
3	440760.460	4146413.310
4	440745.920	4146375.290
5	440728.740	4146357.970
6	440724.580	4146416.280
7	440721.700	4146449.210
8	440711.670	4146081.480
9	440711.560	4146126.860
10	440711.220	4146275.430
11	440705.310	4146130.030
12	440680.970	4146325.340
13	440679.340	4146151.460
14	440676.270	4146300.180
15	440672.920	4146292.200
16	440672.560	4146055.990
17	440672.320	4146157.230
18	440668.980	4146305.180
19	440649.130	4146299.680
20	440645.820	4146232.370
21	440632.000	4146014.270
22	440626.520	4146193.950
23	440624.550	4146229.610
24	440616.987	4146043.520
25	440539.237	4145956.780
26	440533.660	4146182.560
27	440522.250	4145984.250
28	440513.350	4146079.920
29	440509.370	4145938.460
30	440499.560	4145963.140
31	440484.430	4145963.480
32	440480.270	4146198.270
33	440475.440	4146005.690
34	440468.740	4146109.170
35	440464.430	4145931.690
36	440445.880	4145944.180
37	440429.950	4146179.410
38	440368.900	4146254.670
39	440367.740	4146131.240
40	440365.670	4146229.430
41	440359.760	4146140.070
42	440342.030	4146185.290
43	440321.060	4146253.290
44	440280.590	4146249.630

Projeksiyon : UTM 3 Derece
Coğrafi Verilere İlişkin Datum : European 1950 (ED-50)
Dilim Orta Meridyeni : 42 Derece
Dilim Genişliği : 3 Derece

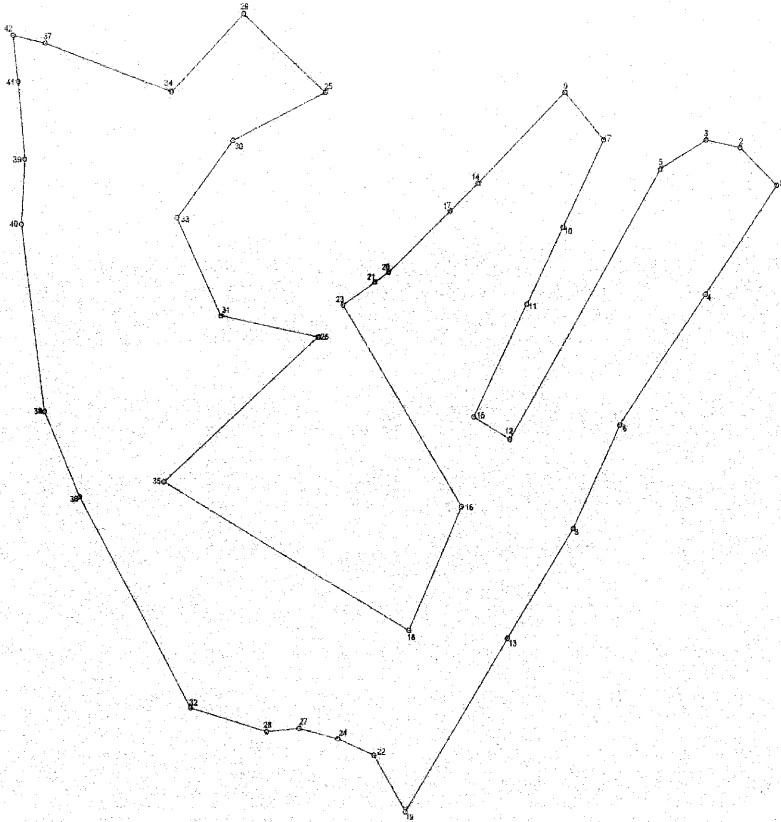
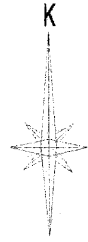

Alan Büyüklüğü : 15.1198 Hektar

MARDİN İLİ , MİDYAT İLÇESİ
IŞIKLAR MAHALLESİ 373 ADA 49 PARSEL
KENTSEL DÖNÜŞÜM VE GELİŞİM PROJE ALANI
SINIR KROKİSİ

MARDİN İLİ , MIDYAT İLÇESİ
IŞIKLAR MAHALLESİ 373 ADA 49 PARSEL
KENTSEL DÖNÜŞÜM VE GELİŞİM PROJE ALANI
KOORDİNAT LİSTESİ

NoktaNo	Y	X
1	445548.490	4140414.850
2	445517.110	4140442.600
3	445488.770	4140448.350
4	445487.520	4140334.510
5	445450.310	4140427.010
6	445414.590	4140238.250
7	445401.950	4140448.580
8	445374.460	4140162.100
9	445369.320	4140483.510
10	445366.964	4140384.080
11	445336.270	4140327.491
12	445321.600	4140227.790
13	445318.650	4140081.200
14	445295.710	4140416.750
15	445291.190	4140244.380
16	445280.460	4140178.350
17	445271.868	4140396.141
18	445235.490	4140087.170
19	445231.670	4139953.560
20	445219.590	4140350.950
21	445207.971	4140343.763
22	445205.510	4139995.120
23	445180.870	4140327.000
24	445175.000	4140007.140
25	445167.070	4140483.430
26	445160.330	4140303.540
27	445142.500	4140015.120
28	445115.000	4140012.500
29	445098.150	4140541.320
30	445088.450	4140448.150
31	445077.700	4140318.870
32	445050.120	4140030.140
33	445040.560	4140390.960
34	445036.410	4140483.710
35	445028.430	4140196.510
36	444957.450	4140185.450
37	444930.000	4140519.640
38	444928.100	4140248.140
39	444912.570	4140434.150
40	444909.490	4140386.150
41	444907.220	4140491.400
42	444903.210	4140525.320

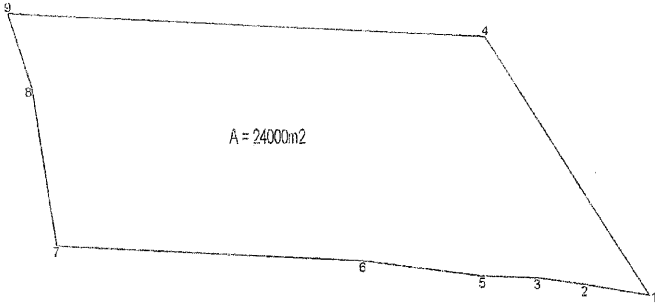

Alan Büyüklüğü : 2.4 Hektar

MARDİN İLİ , MİDYAT İLÇESİ
IŞIKLAR MAHALLESİ 373 ADA 58 PARSEL
KENTSEL DÖNÜŞÜM VE GELİŞİM PROJE ALANI
SINIR KROKİSİ

MARDİN İLİ , MİDYAT İLÇESİ
IŞIKLAR MAHALLESİ 373 ADA 58 PARSEL
KENTSEL DÖNÜŞÜM VE GELİŞİM PROJE ALANI
KOORDİNAT LİSTESİ

NoktaNo	Y	X
1	445567.990	41 40624.770
2	445537.480	41 40629.480
3	44551 4 780	41 40632.090
4	445490.462	41 40731 51 2
5	445488.810	41 40632.650
6	445432.720	41 40638.830
7	445288.1 30	41 40644.790
8	445276.360	41 40710.21 0
9	445265.1 22	41 40740.801

Projeksiyon : UTM 3 Derece
Coğrafi Verilere İlişkin Datum : European 1950 (ED-50)
Dilim Orta Meridyeni : 42 Derece
Dilim Geniřliđi : 3 Derece

K

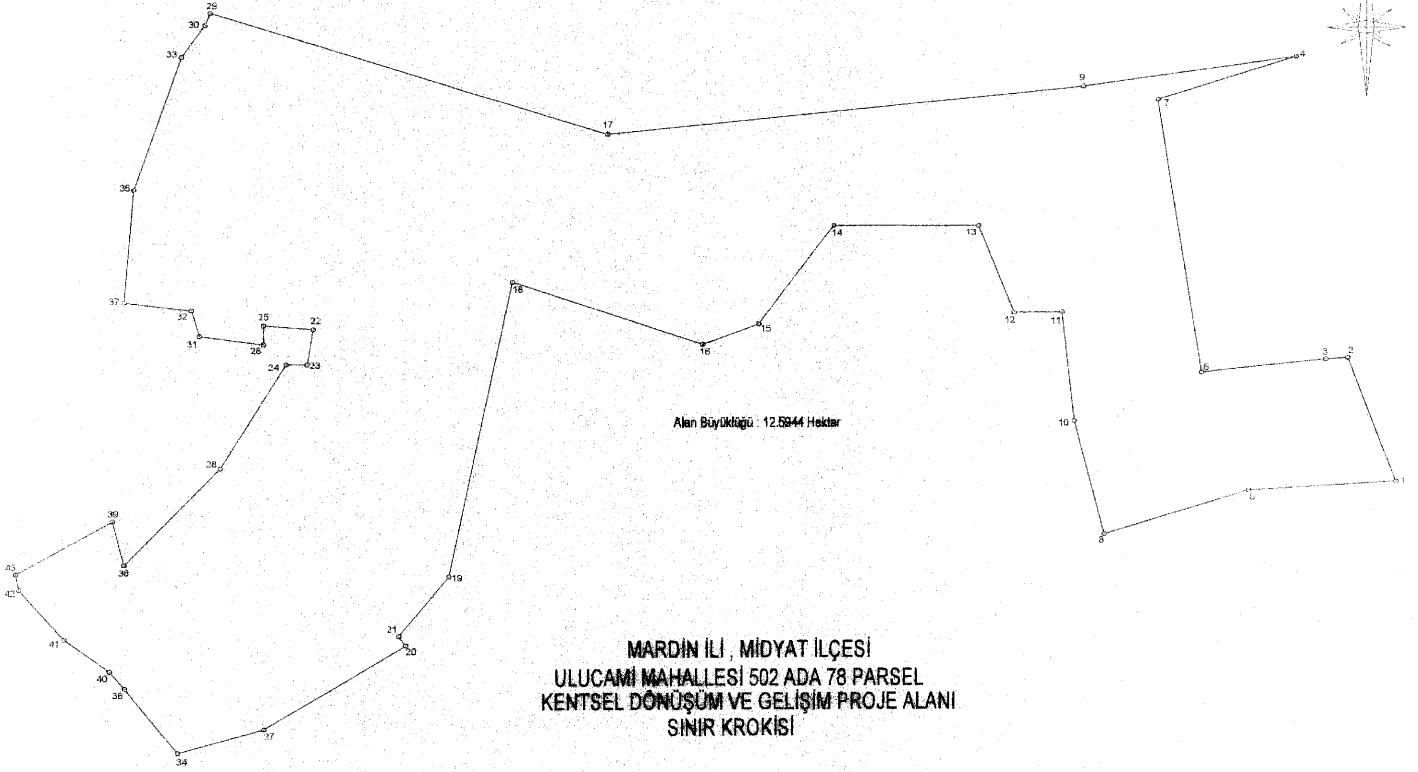

Alan Büyüklüğü : 12.5844 Hektar

**MARDIN İLİ , MİDYAT İLÇESİ
ULUCAMI MAHALLESİ 502 ADA 78 PARSEL
KENTSEL DÖNÜŞÜM VE GELİŞİM PROJE ALANI
SINIR KROKİSİ**

MARDİN İLİ , MİDYAT İLÇESİ
ULUCAMI MAHALLESİ 502 ADA 78 PARSEL
KENTSEL DÖNÜŞÜM VE GELİŞİM PROJE ALANI
KOORDİNAT LİSTESİ

NoktaNo	Y	X
1	439246.890	4143582.480
2	439220.970	4143658.660
3	439208.970	4143657.660
4	439192.630	4143844.250
5	439166.980	4143577.180
6	439141.770	4143649.810
7	439118.130	4143818.170
8	439089.430	4143550.540
9	439078.210	4143826.540
10	439073.250	4143620.240
11	439066.520	4143687.250
12	439040.770	4143686.900
13	439021.700	4143740.610
14	438943.400	4143741.050
15	438902.680	4143680.400
16	438872.480	4143667.900
17	438821.200	4143797.450
18	438769.710	4143706.460
19	438735.240	4143525.070
20	438711.870	4143482.720
21	438708.260	4143488.580
22	438662.050	4143677.850
23	438658.800	4143656.100
24	438647.490	4143656.110
25	438635.330	4143680.200
26	438635.240	4143668.500
27	438635.220	4143432.050
28	438611.920	4143592.570
29	438606.390	4143872.925
30	438603.624	4143865.328
31	438600.700	4143673.800
32	438596.400	4143689.600
33	438590.945	4143845.697
34	438588.746	4143417.581
35	438565.380	4143764.230
36	438560.040	4143457.460
37	438559.990	4143694.490
38	438559.860	4143532.990
39	438553.600	4143560.250
40	438551.814	4143467.853
41	438527.330	4143487.500
42	438502.979	4143517.942
43	438501.210	4143527.669

Projeksiyon : UTM 3 Derece
Coğrafi Verilere İlişkin Datum : European 1950 (ED-50)
Dilim Orta Meridyani : 42 Derece
Dilim Genişliği : 3 Derece